

Key

 Proposed new 'No Waiting At Any Time' restriction

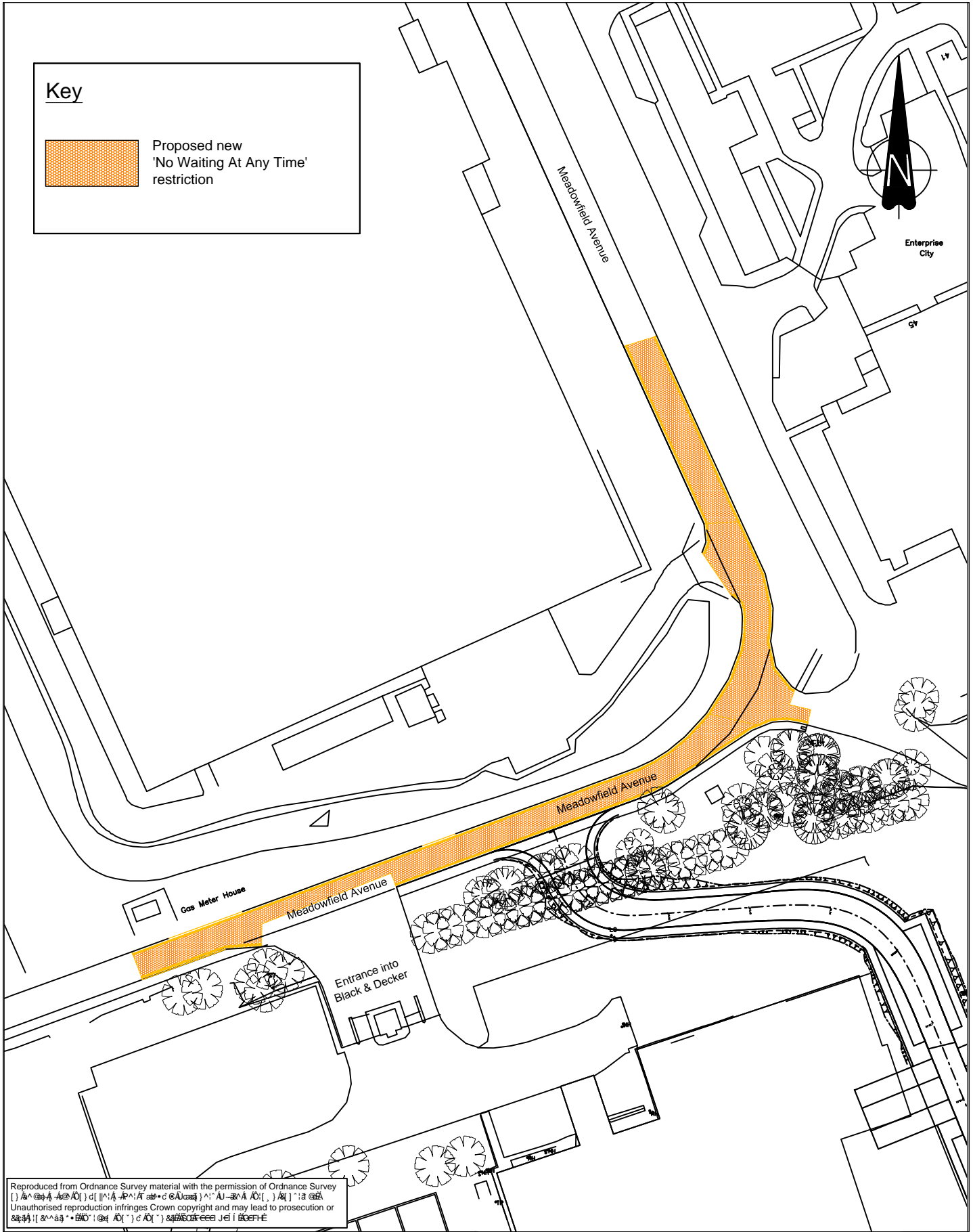

Reproduced from Ordnance Survey material with the permission of Ordnance Survey
 Unauthorised reproduction infringes Crown copyright and may lead to prosecution or
 civil proceedings

| Rev/ Amdt | Drawn By | | Approved By | | | Description Of Amendments |
|--------------|-----------|---------|-------------|---------|------|------------------------------|
| | Name | Date | Name | Date | Sign | |
| 0/- | P.Everett | 10.8.12 | L.Mowbray | 10.8.12 | | |
| | | | | | | |
| | | | | | | |
| | | | | | | |



Durham
County Council

**STRATEGIC
TRAFFIC
MANAGEMENT**

**CORPORATE DIRECTOR OF
REGENERATION & ECONOMIC
DEVELOPMENT**

COUNTY HALL, DURHAM. DH1 5UQ

| | |
|--|-----------------------------------|
| Project Meadowfield Avenue, Tudhoe | |
| Drawing Proposed 'No Waiting At Any Time' Restriction | |
| Scales 1:1250 @A4 | Project/Drawing No. APPENDIX 1 |